

PRODUCT DATA SHEET

Product view



Product information

QR Code



| | |
|---------------|---|
| Product group | Wall Duct KG |
| Item number | CRA22171 |
| EAN-Code | 4260182347188 |
| Product name | Wall Duct KG DN 500, for wall thickness 35 cm |

Technical drawing

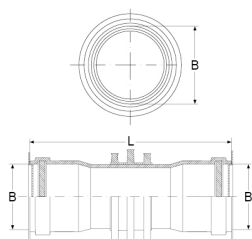

Specification

| | |
|---------------------------|------------|
| A Outside-diameter (mm) | - |
| B Inside-diameter (mm) | 500 |
| L Length (mm) | 350 |
| Pressure (bar) | 2.5 |
| Tightening torque (Nm) | - |
| Weight (kg) | 11.8 |
| Material | PVC / EPDM |

Product description

For the installation in waterproof concrete to connect on both sides HT/KG-pipes; form and pressure stable solid wall pipe; water pressure-tight, vulcanized Power-Profile to prevent ingress of odor, gas or water; connecting socket on both sides; 2 end caps as installation aid

Certificates and approvals

| | |
|-------|-----|
| MPA | Yes |
| CE | - |
| DIBT | - |
| SITAC | - |
| ETA | - |

Stable properties

| | |
|---------------------------------|-----|
| Heat-resistant (Celsius Degree) | - |
| Cold-resistant (Celsius degree) | - |
| UV-resistant | Yes |
| Ground-suited | Yes |
| Flush-mounting suited | Yes |

