

PRODUCT DATA SHEET

Product view



Product information

QR Code



Product group	Wall Duct KG Double Socket
Item number	CRA22200
EAN-Code	4260182347478
Product name	Wall Duct KG Double Socket DN 400

Technical drawing

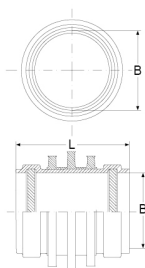

Specification

A Outside-diameter (mm)	-
B Inside-diameter (mm)	400
L Length (mm)	120
Pressure (bar)	2.5
Tightening torque (Nm)	-
Weight (kg)	7
Material	PVC / EPDM

Product description

For the installation in waterproof concrete as feed-through for HT/KG-pipes; form and pressure stable solid wall pipe; water pressure-tight, vulcanized Power-Profile to prevent ingress of odor, gas or water

Certificates and approvals

MPA	Yes
CE	-
DIBT	-
SITAC	-
ETA	-

Stable properties

Heat-resistant (Celsius Degree)	-
Cold-resistant (Celsius degree)	-
UV-resistant	Yes
Ground-suited	Yes
Flush-mounting suited	Yes

