

PRODUCT DATA SHEET

Product view



Product information

QR Code



Product group	Floor Drain Frost-proof Sealing Flange
Item number	CRA22803KG2
EAN-Code	4260431850216
Product name	Floor Drain Frost-proof KG2000 with Sealing Flange

Technical drawing

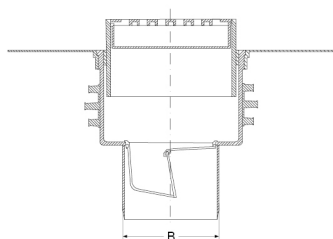

Specification

A Stainless steel grate (mm)	150x150
B Connection pipe ø (mm)	DN 110
L Length (mm)	-
Pressure (bar)	2.5
Tightening torque (Nm)	-
Weight (kg)	1.1
Material	PP / EPDM

Product description

For the installation in outdoor areas without traffic, drainage for gray water, drainage capacity: 1,67 l/s; water pressure-tight, circumferential Power-Profile; with oil- and bitumen-resistant foil flange (circumferential 30 cm); screwed stainless steel grate class K3 (maximum load up to 300 kg) 15x15 cm, frost-proof odor trap, sludge trap and protective cap (for construction period), height: floor drain about 110 mm, extension frame is infinitely adjustable 30 - 70 mm and twistable, connection to HT/KG-pipes DN 110 vertical

Certificates and approvals

MPA	Yes
CE	-
DIBT	-
SITAC	-
ETA	-

Stable properties

Heat-resistant (Celsius Degree)	-
Cold-resistant (Celsius degree)	-
UV-resistant	Yes
Ground-suited	Yes
Flush-mounting suited	Yes

